

***** Read Me(Smartball Galaxy) *****

Thank you for buying Smartball Galaxy.

First, Rez the Smartball Galaxy and place it where you like.

Then touch the front panel("Smartball Galaxy" is written) to show owner menu.

Choose "RezPanel" to rez top panel, which is phantom object and not linked to main.

And choose "Reset" to make the machine memorize present pits position (important!).

Also you can choose initial ball count(5 to 25) and Views(1,2,3) while playing.

Player have to sit the machine before starting a play.

To shoot a ball, keep pushing down your back-arrow key to charge energy and release.

When initial ball counts are all used, you can start a new game by touching the machine.

You can tilt the machine by right (or left) arrow-key. Also you can punch the machine by forward arrow-key.

Enjoy!

The Picture below shows How to show Owner menu.

As shown by red circle, Reset (when you place the machine) is important to make it work properly.

Also, don't forget to Rez top-panel by "RezPanel".

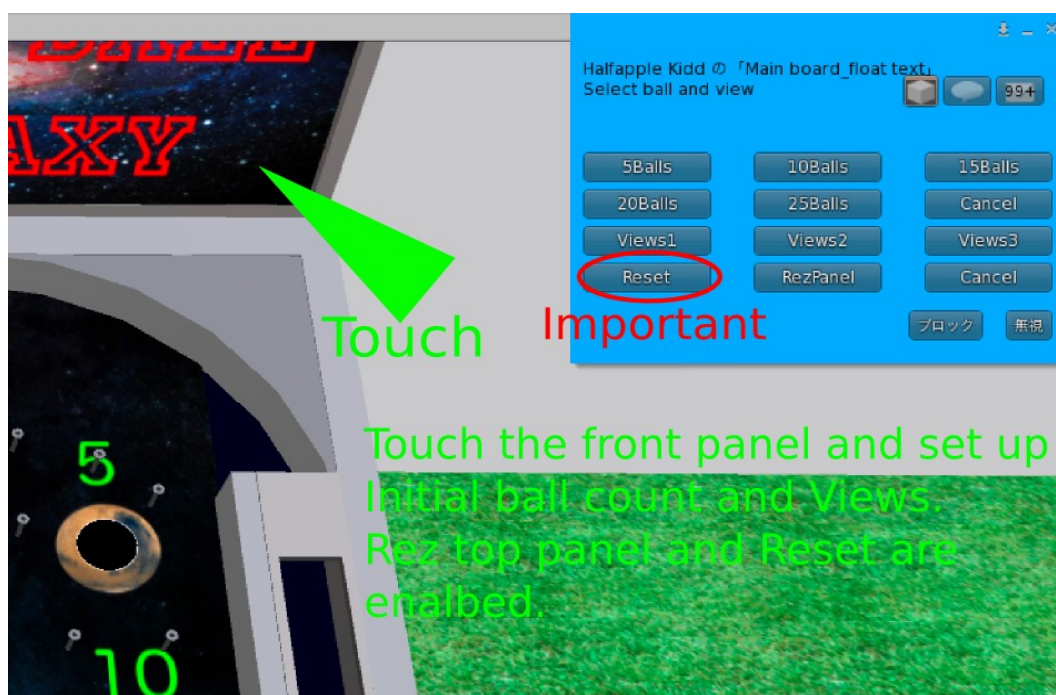

The picture below shows how to play Smartball Galaxy(very simple...).
This texture and pasted panel-object are enclosed within the Folder.

Smartball Galaxy

How to play

- 1.Sit the machine before play
- 2.Push down back arrow-key,hold and release to shoot a ball
- 3.When one game ends, touch the machine to start new game
- 4.If you want to tilt the machine, use right or left arrow-key
- 5.If you want to hit the machine, use forward arrow-key

